

T.1N. ATWATER R.7W.

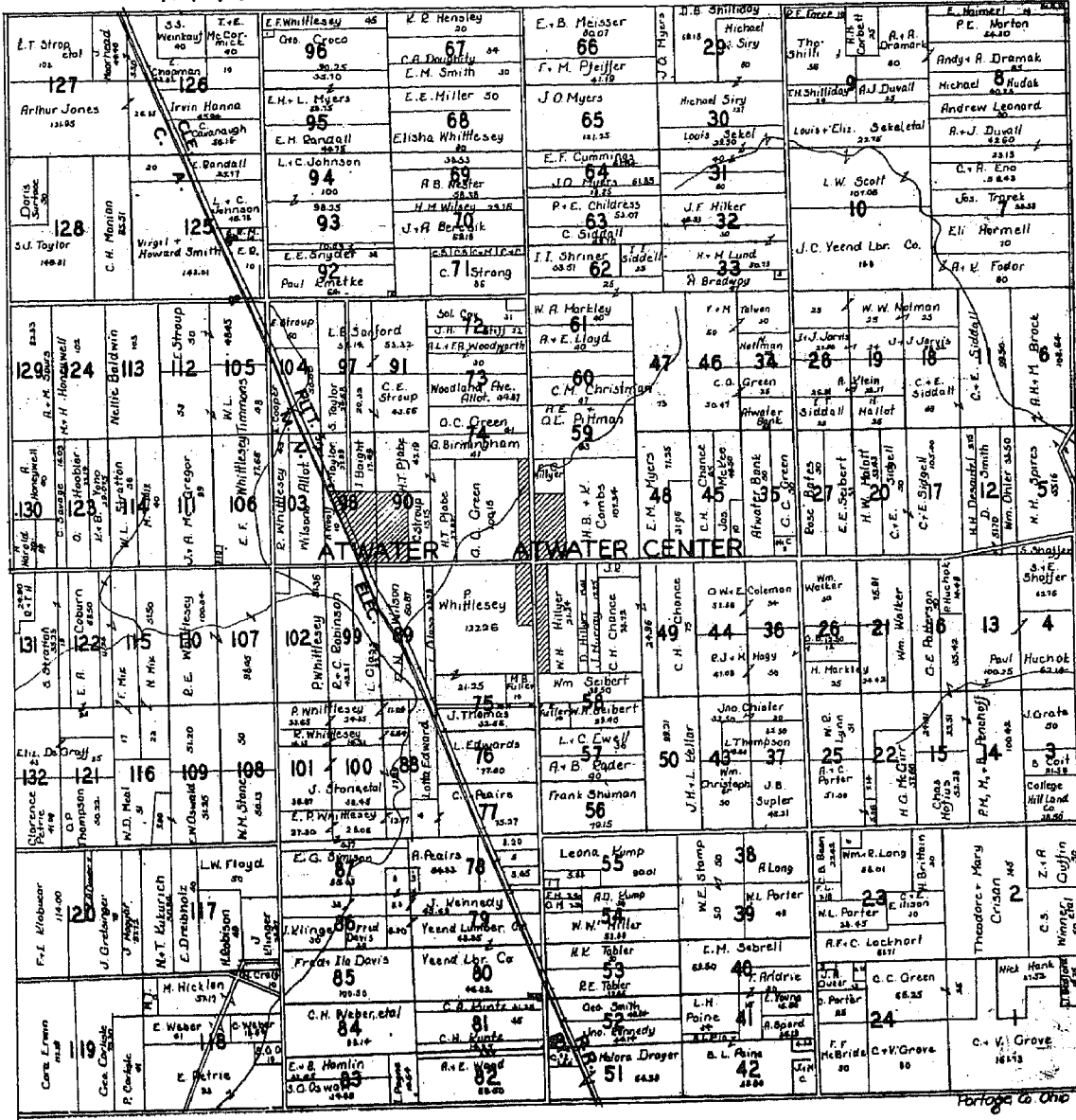

1931
PORTAGE COUNTY
PLAT BOOK
COURTESY OF
MARGARET
HUBBELL COOK
"Leon Hubbell Estate"

T.5N. AURORA R.9W.

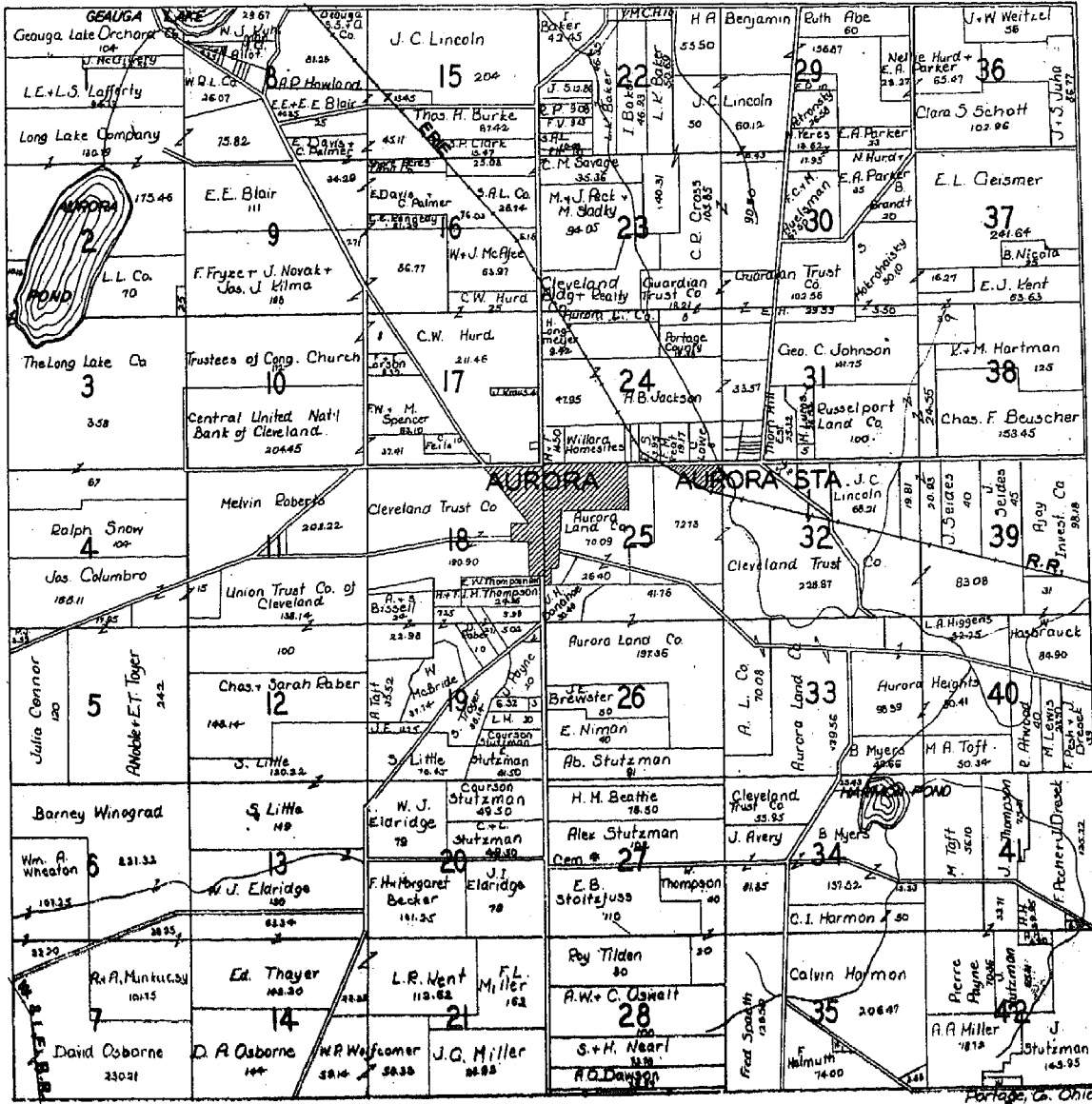

T. 2 N.

BRIMFIELD

R. 9 W.

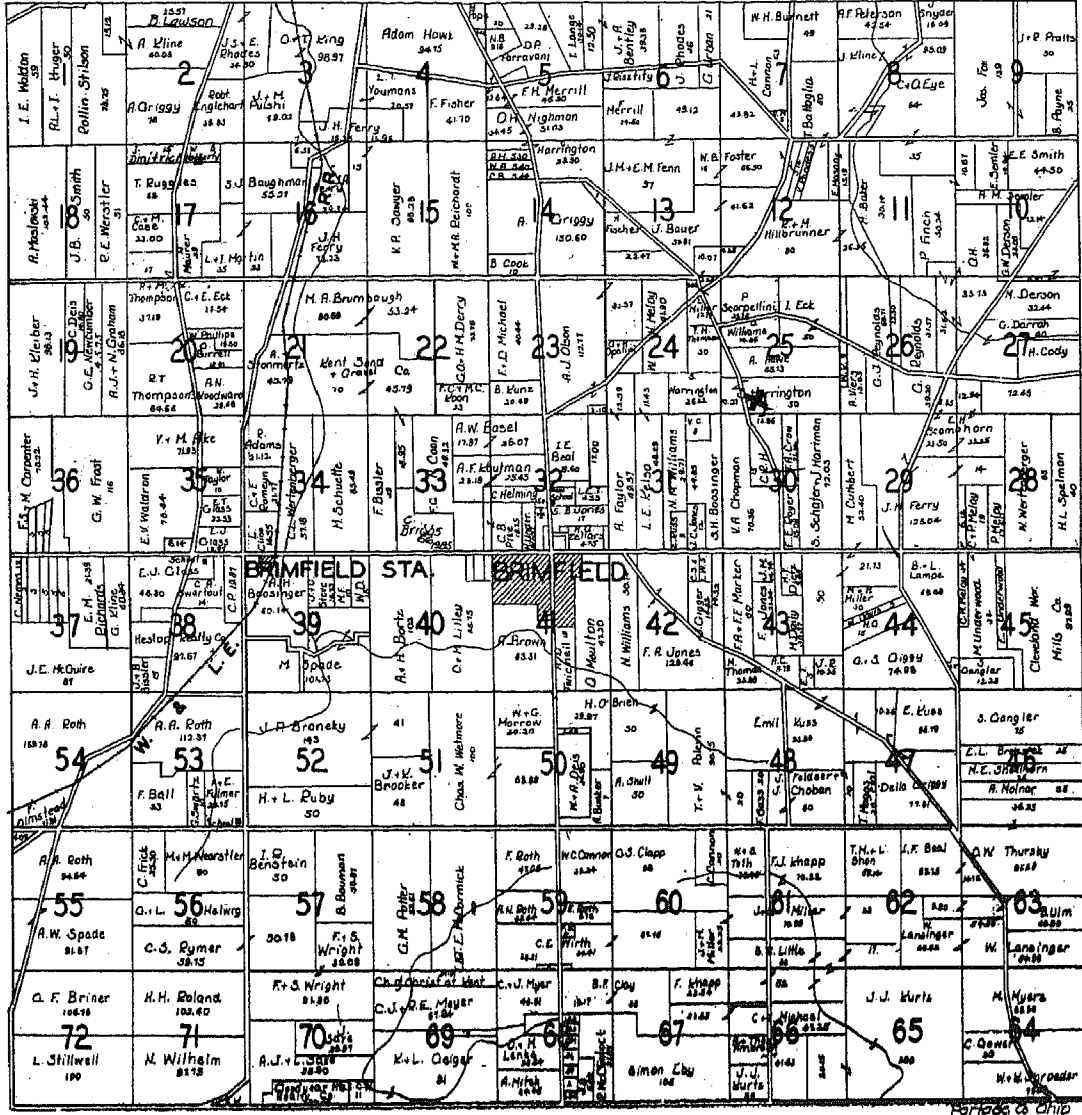

T. 3 N.

CHARLESTOWN

R. 7 W.

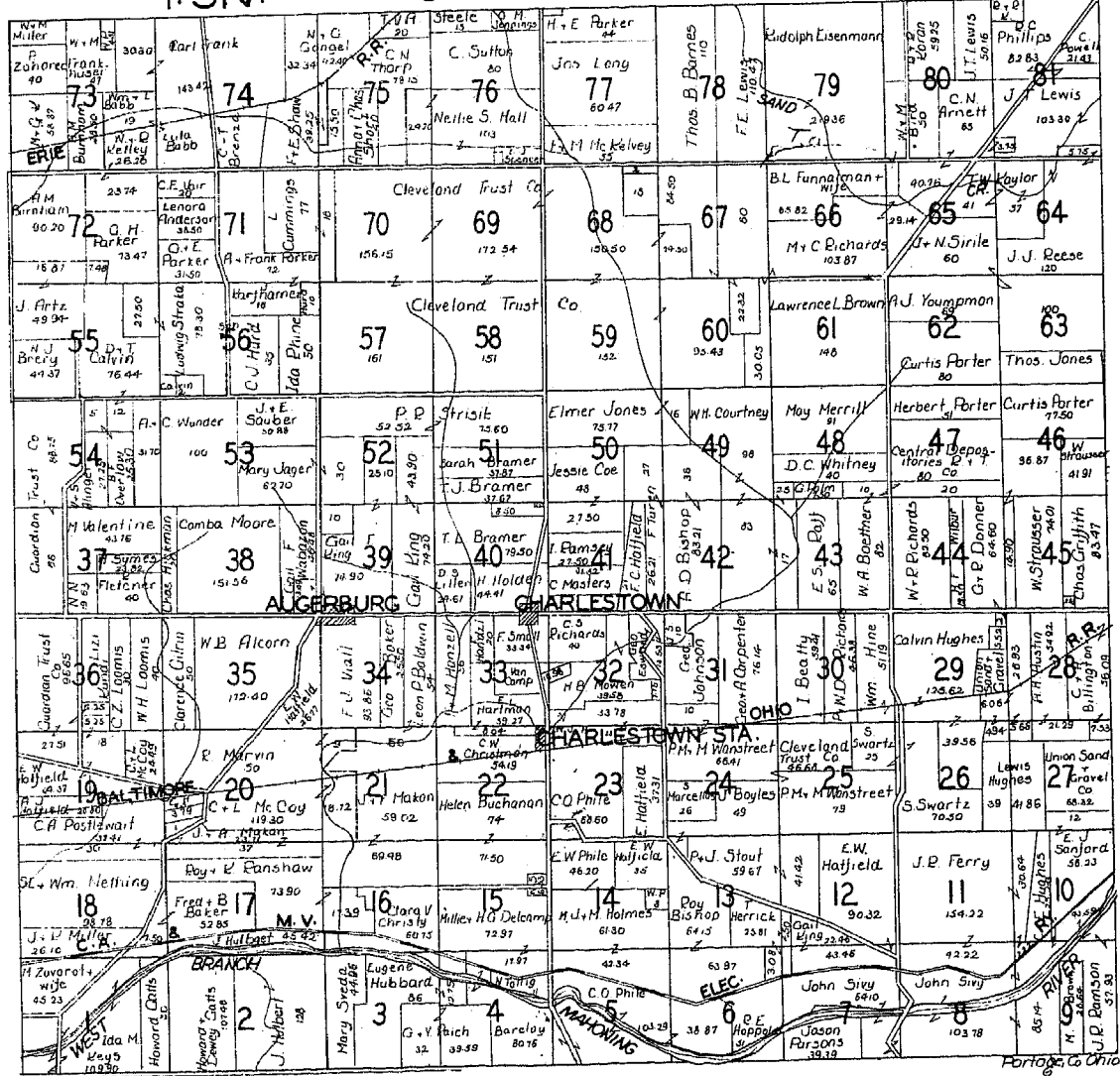

T. 1 N. DEERFIELD R. 6 W.

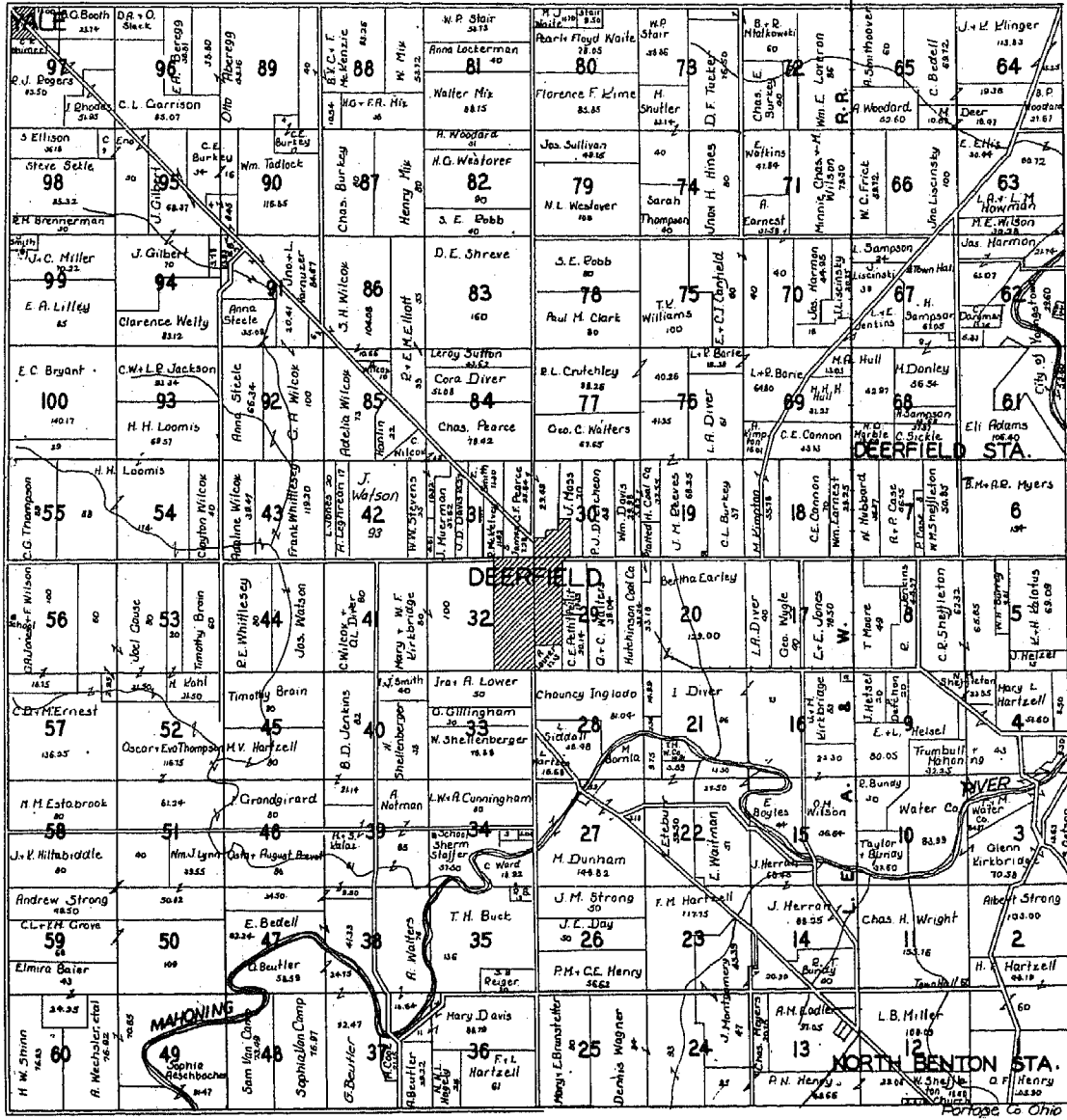

T. 2 N. EDINBURG R. 7 W.

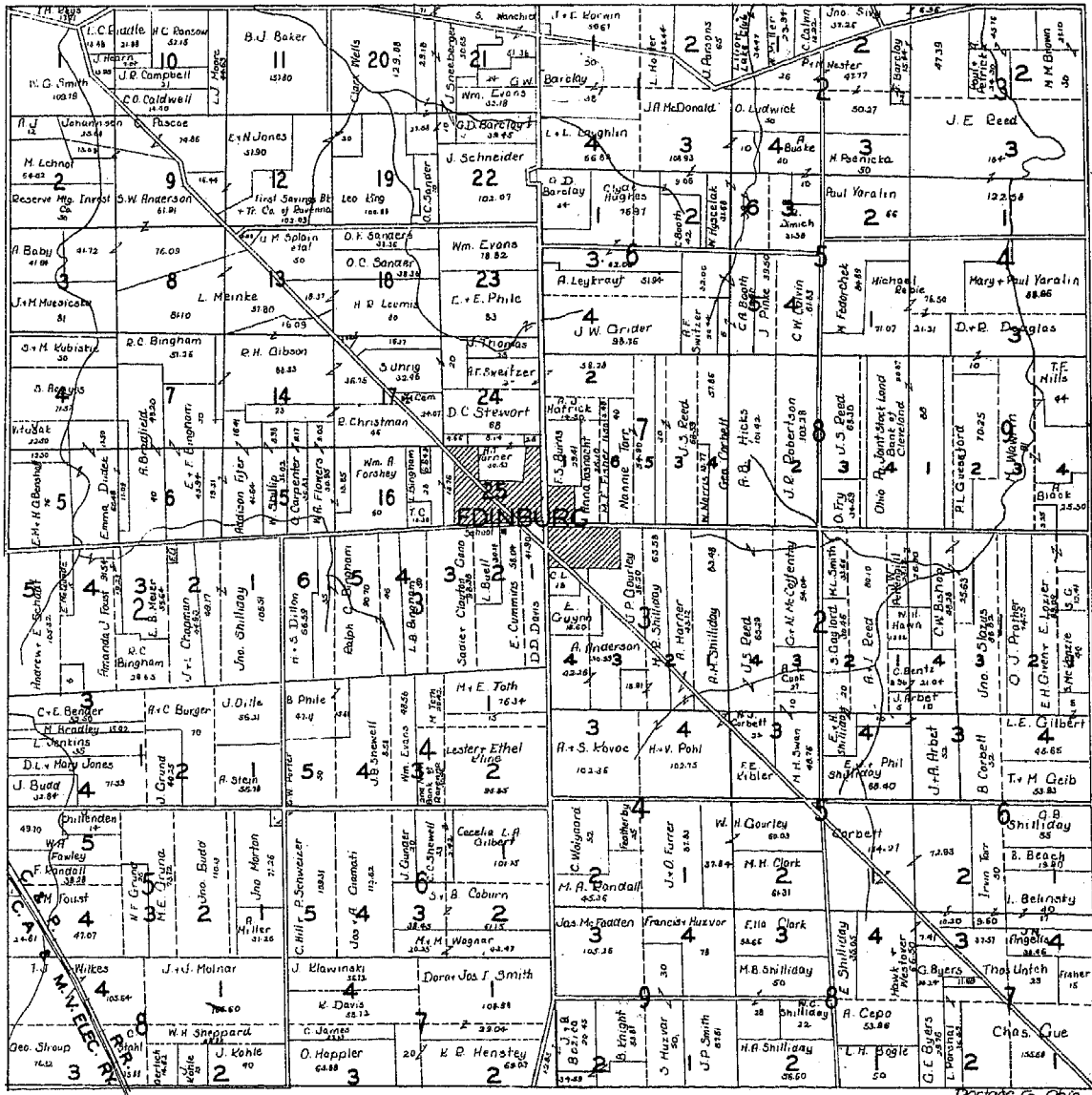

T.3N. FRANKLIN R.9W.

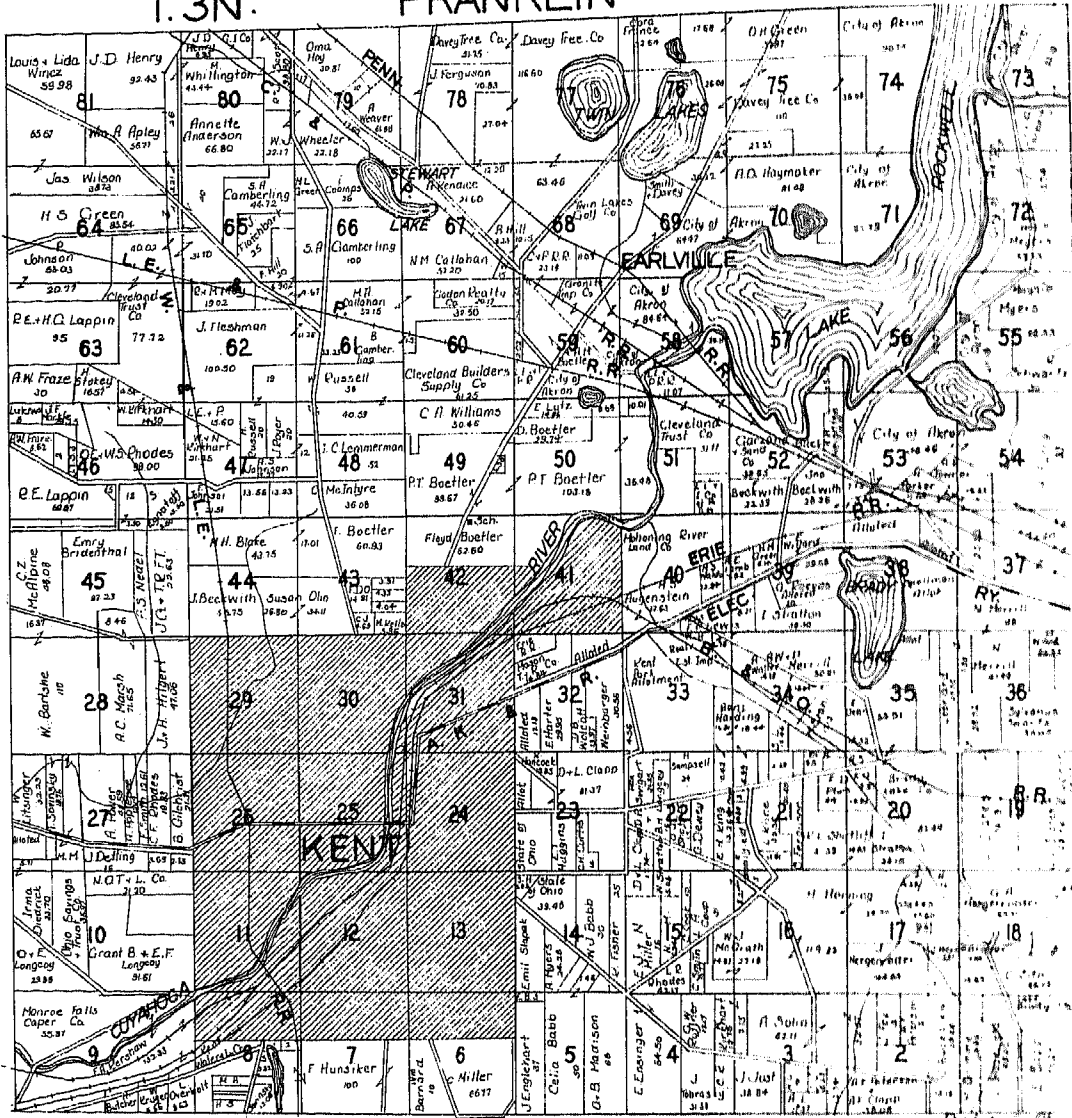

T.4N. FREEDOM R.7W.

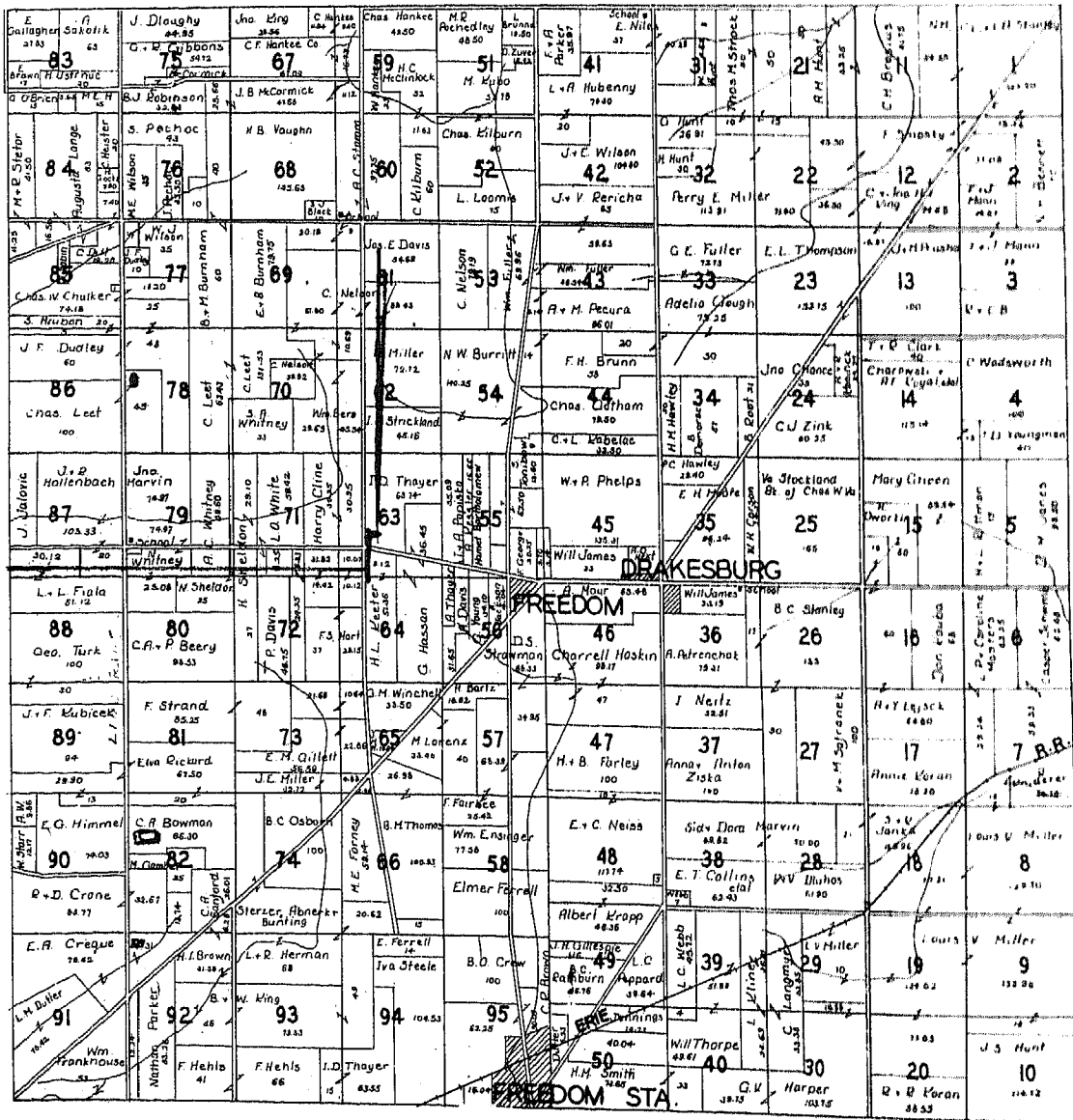

J.M.P. Hudson

CO.

SUMMIT

T.5N.

HIRAM

R.7W.

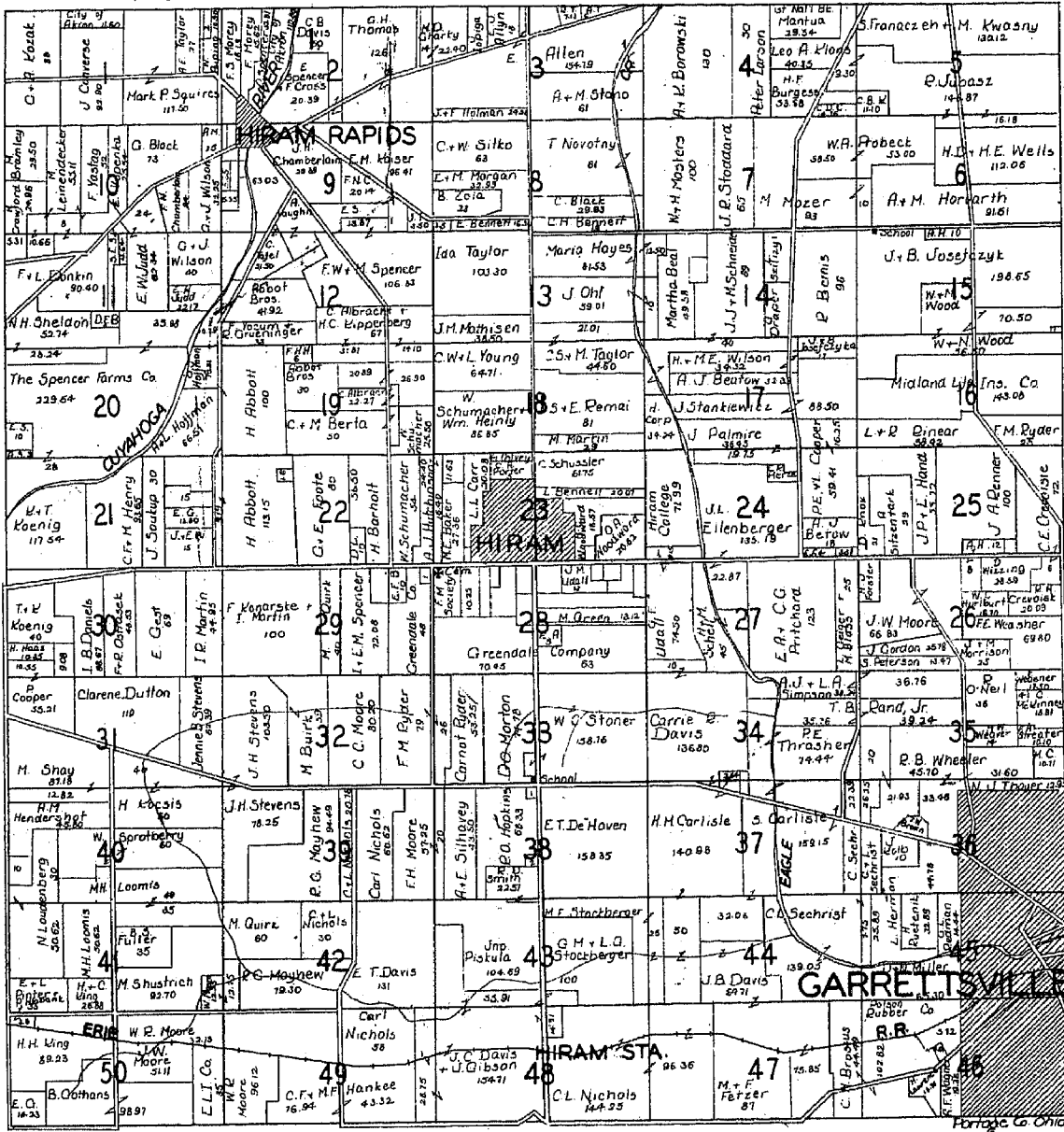

T.5N.

MANTUA

R.8W.

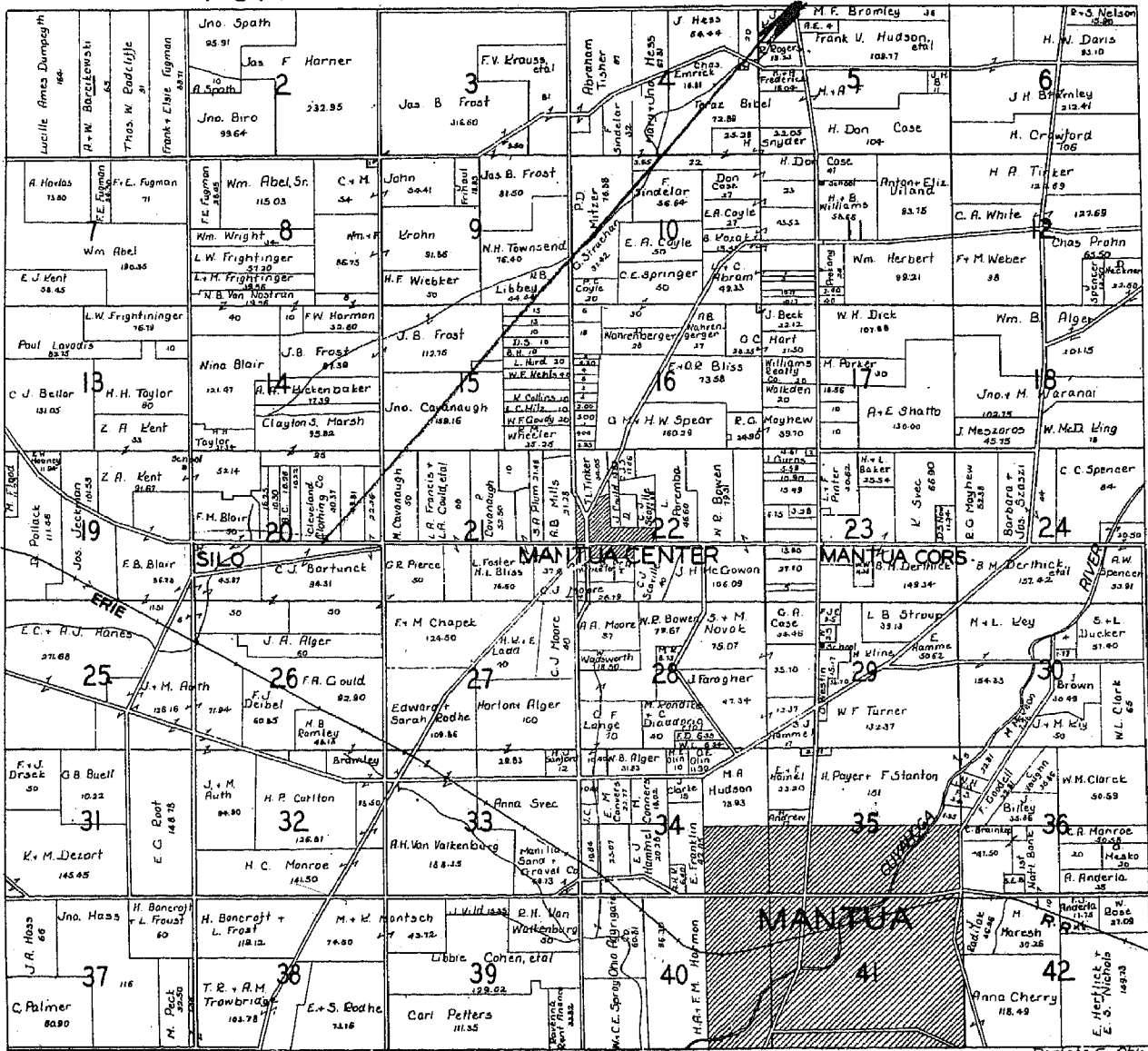

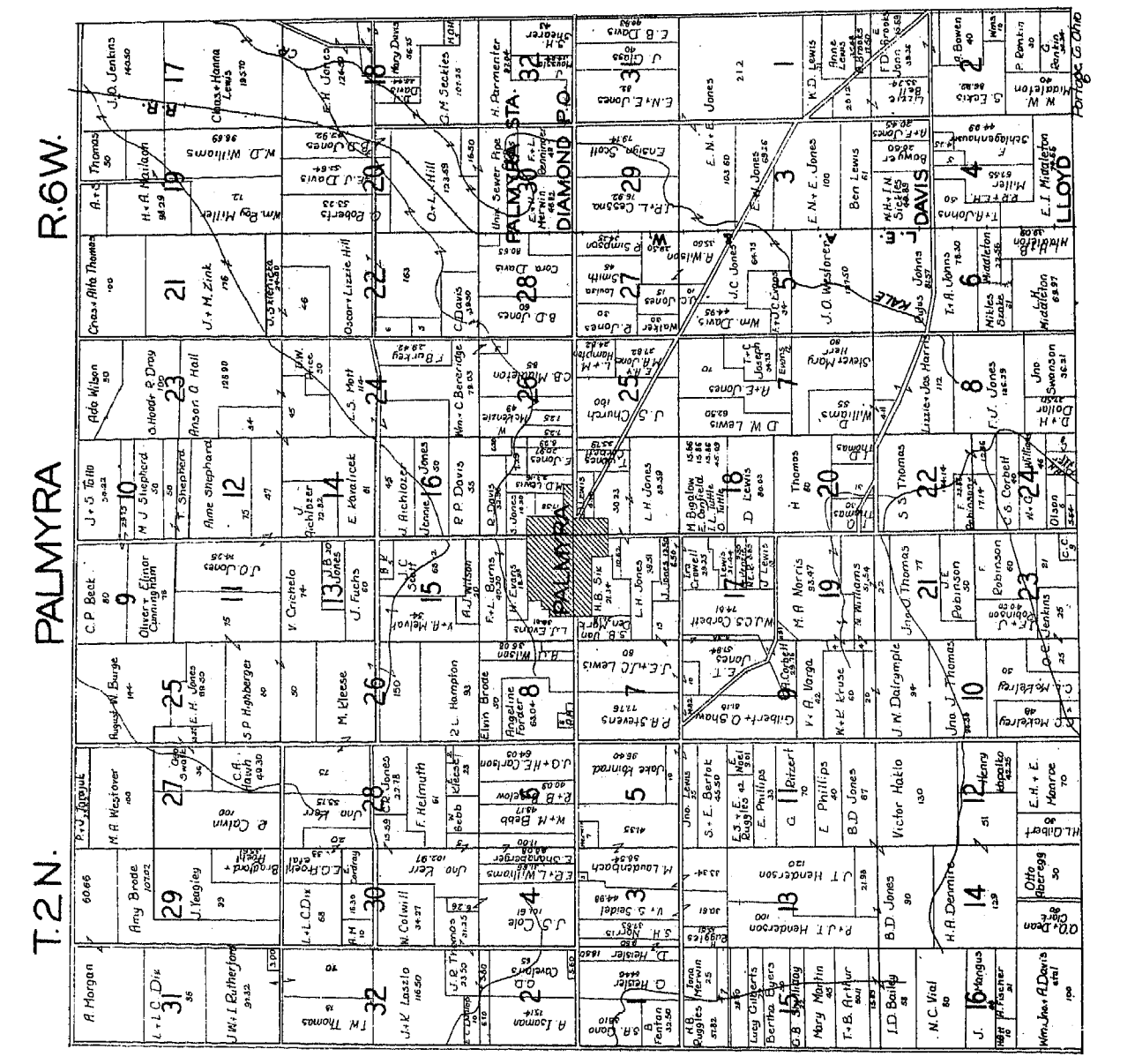
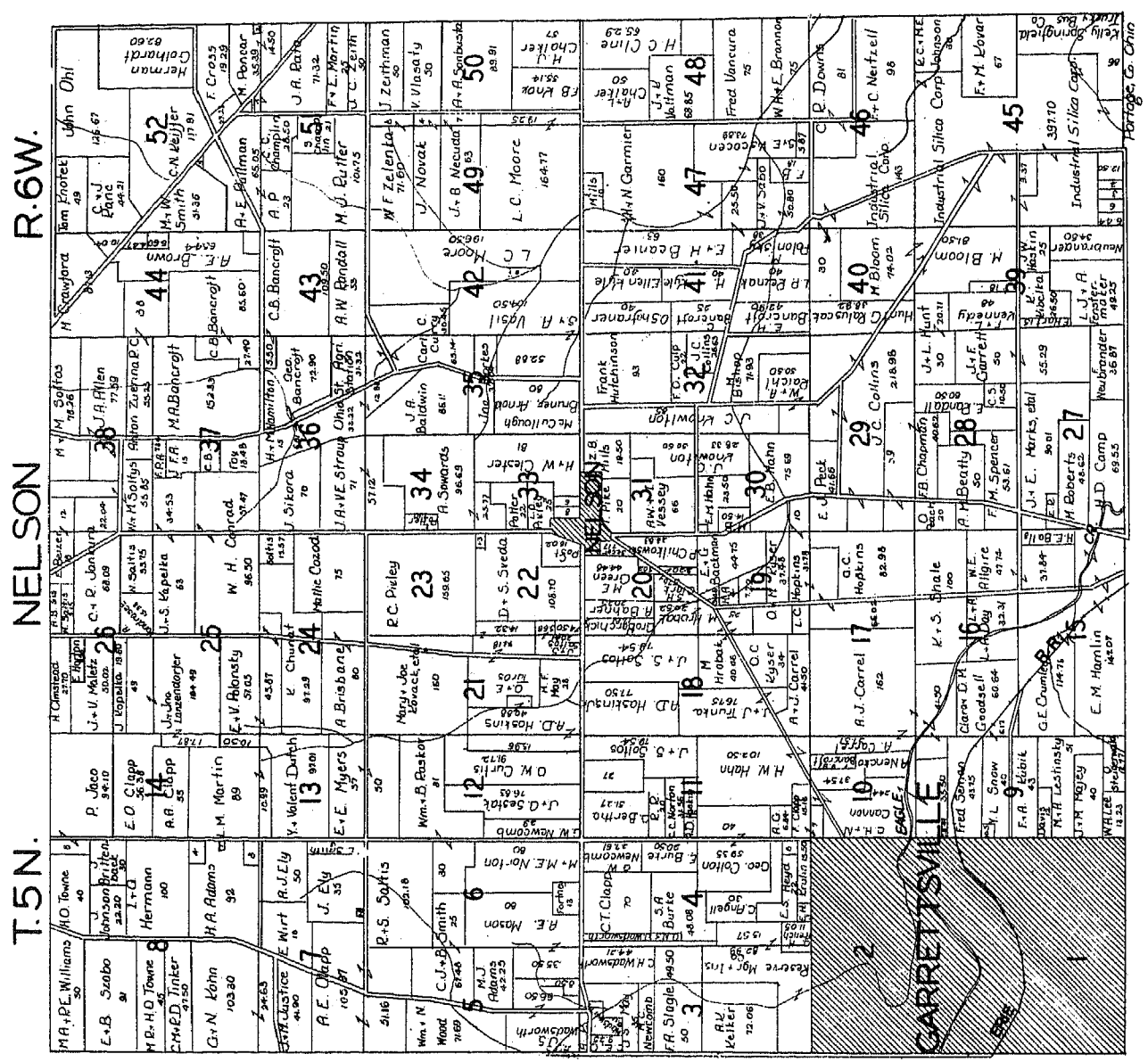

T.3N.

PARIS

R.6W.

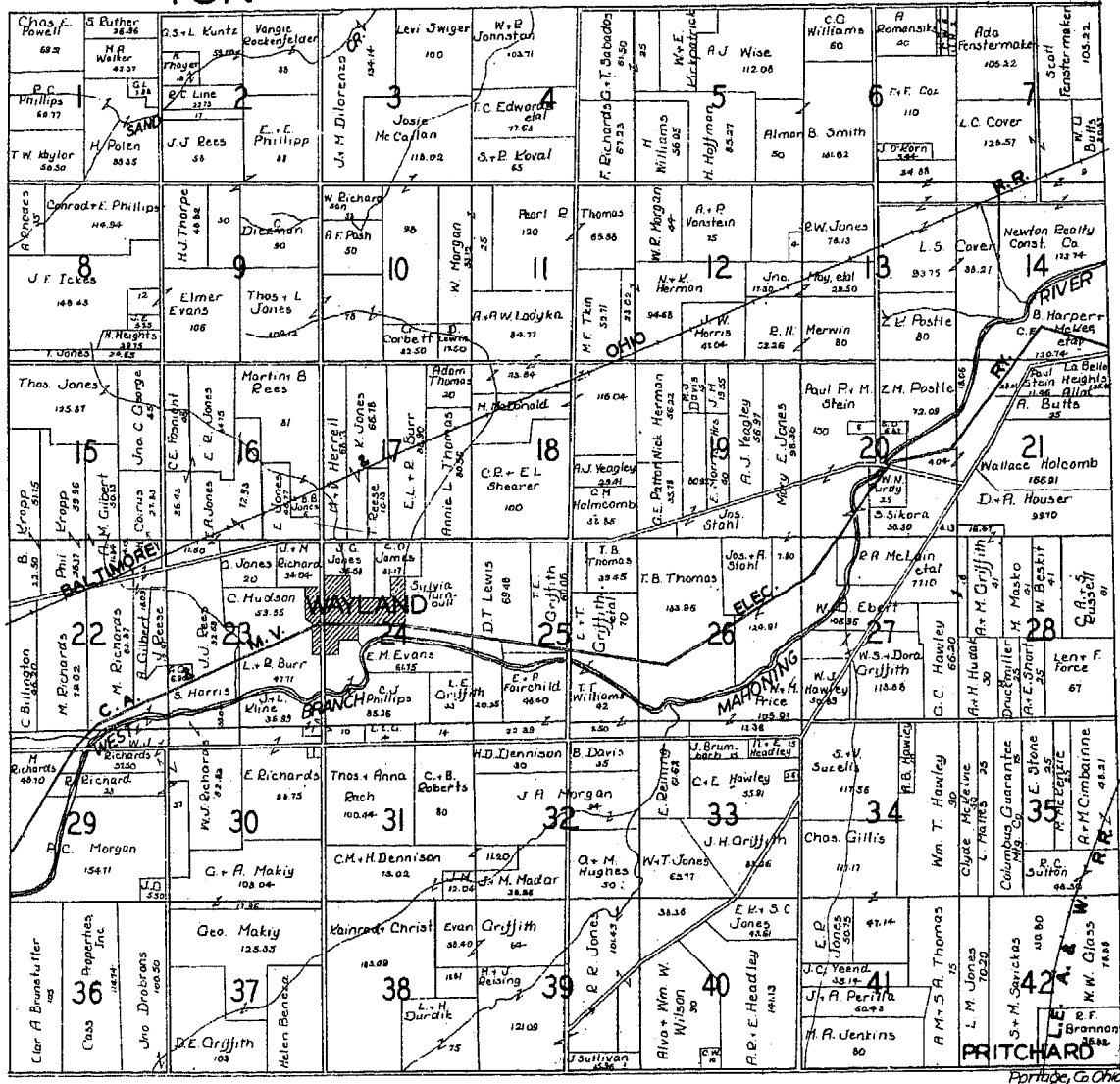

T.1N.

RANDOLPH

R.8W.

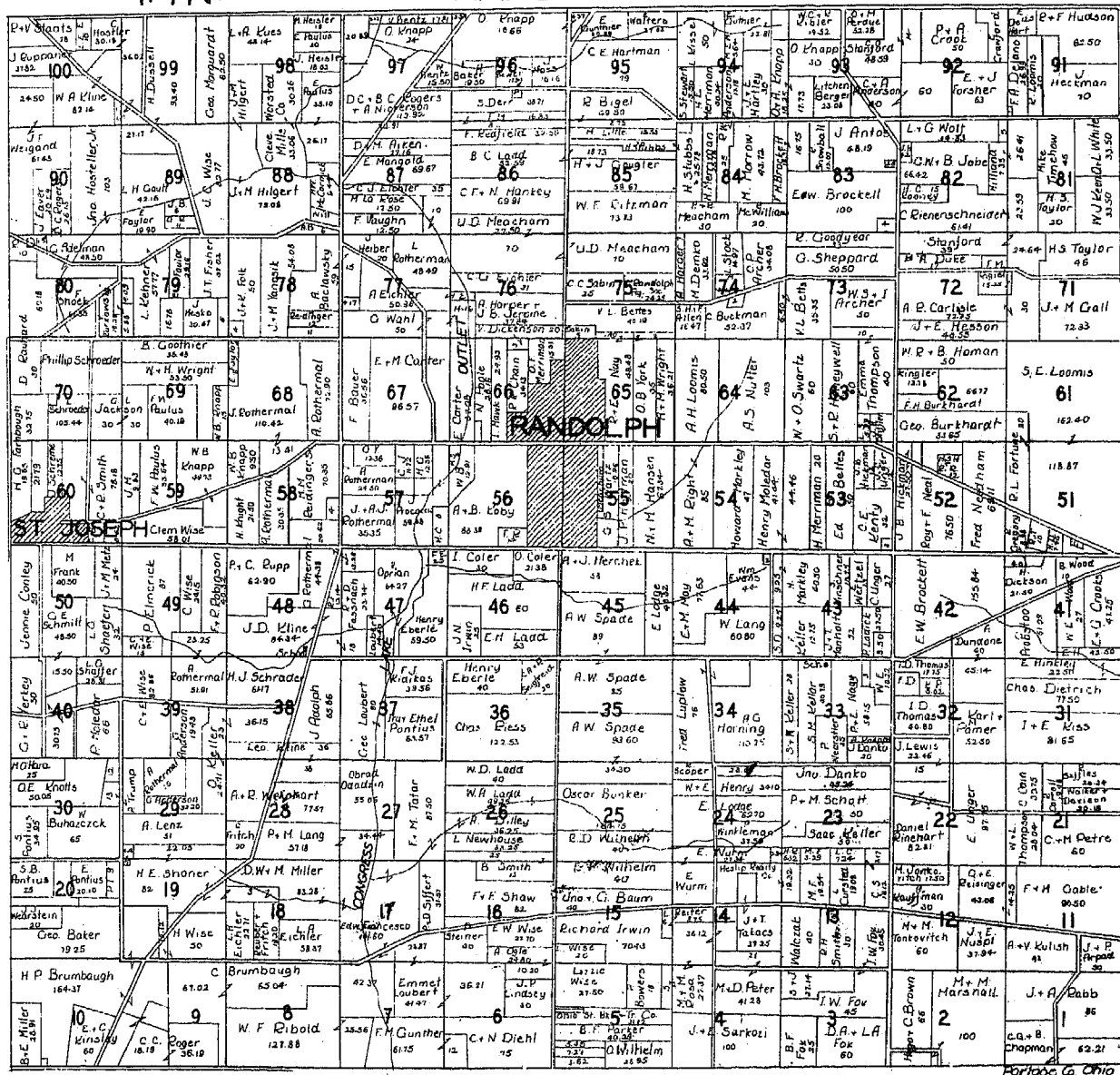

T.3N.

RAVENNA

R.8W.

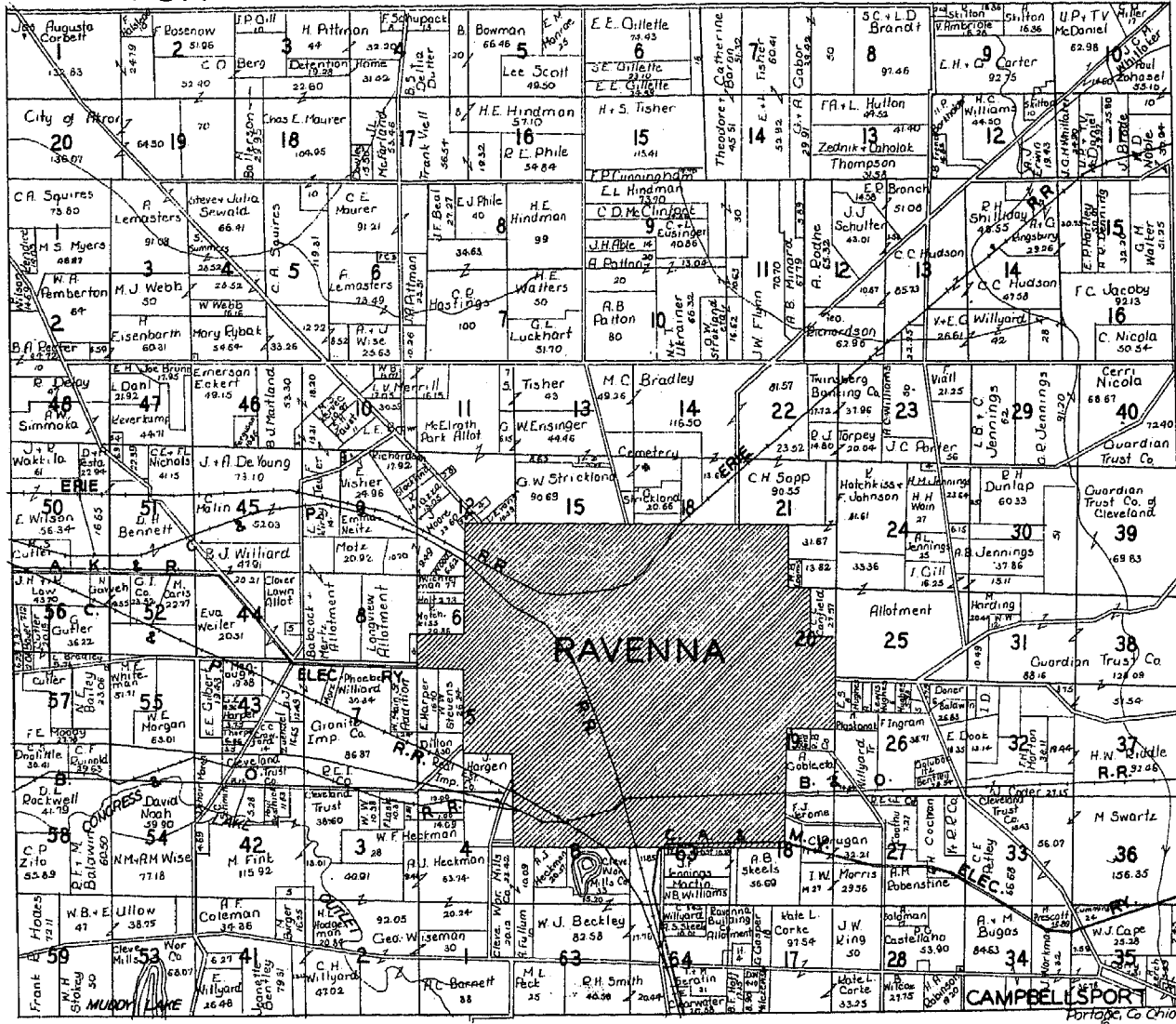

T.2N.

ROOTSTOWN

R.8W.

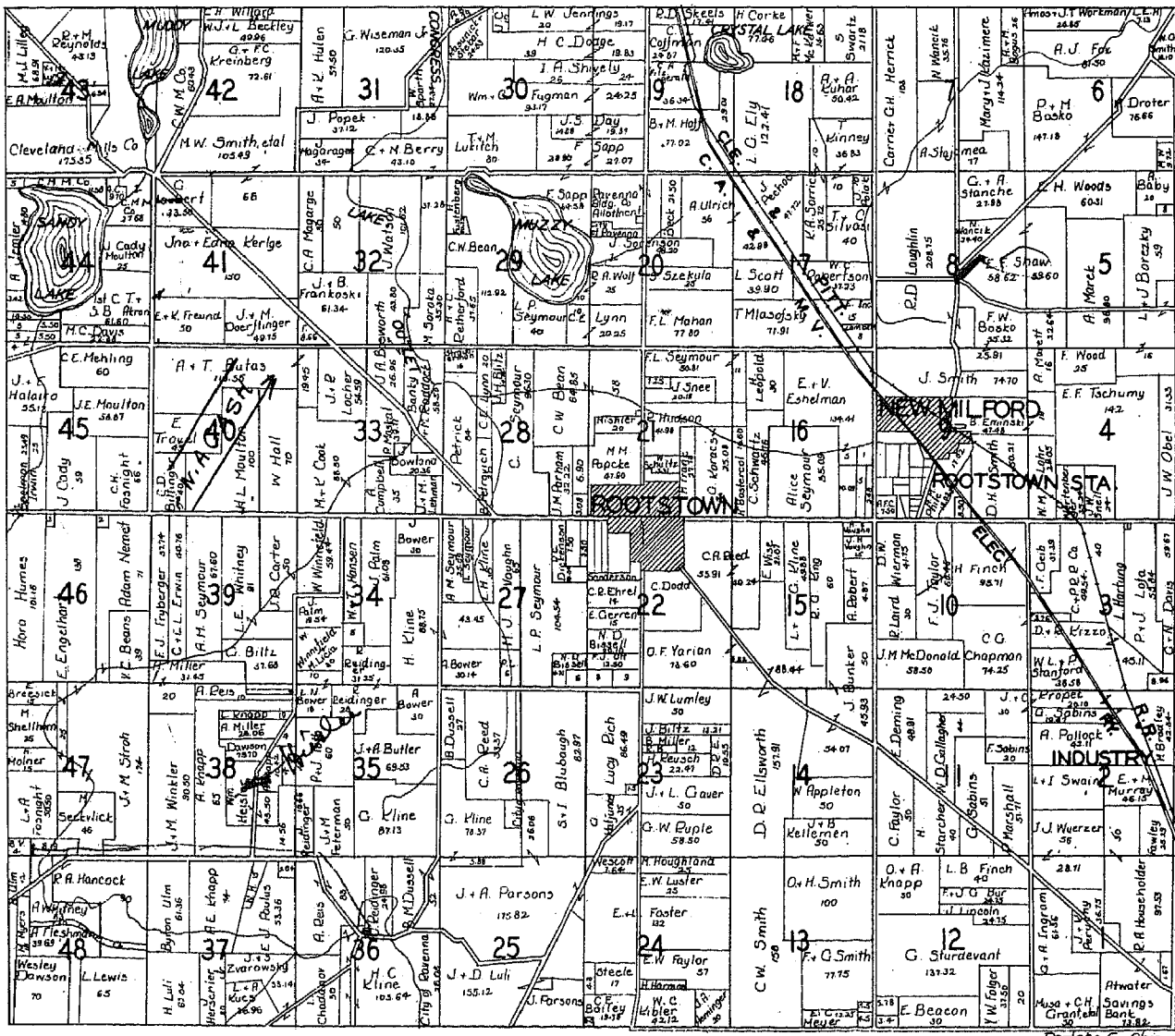

T. 4 N.

SHALERSVILLE

R. 8 W.

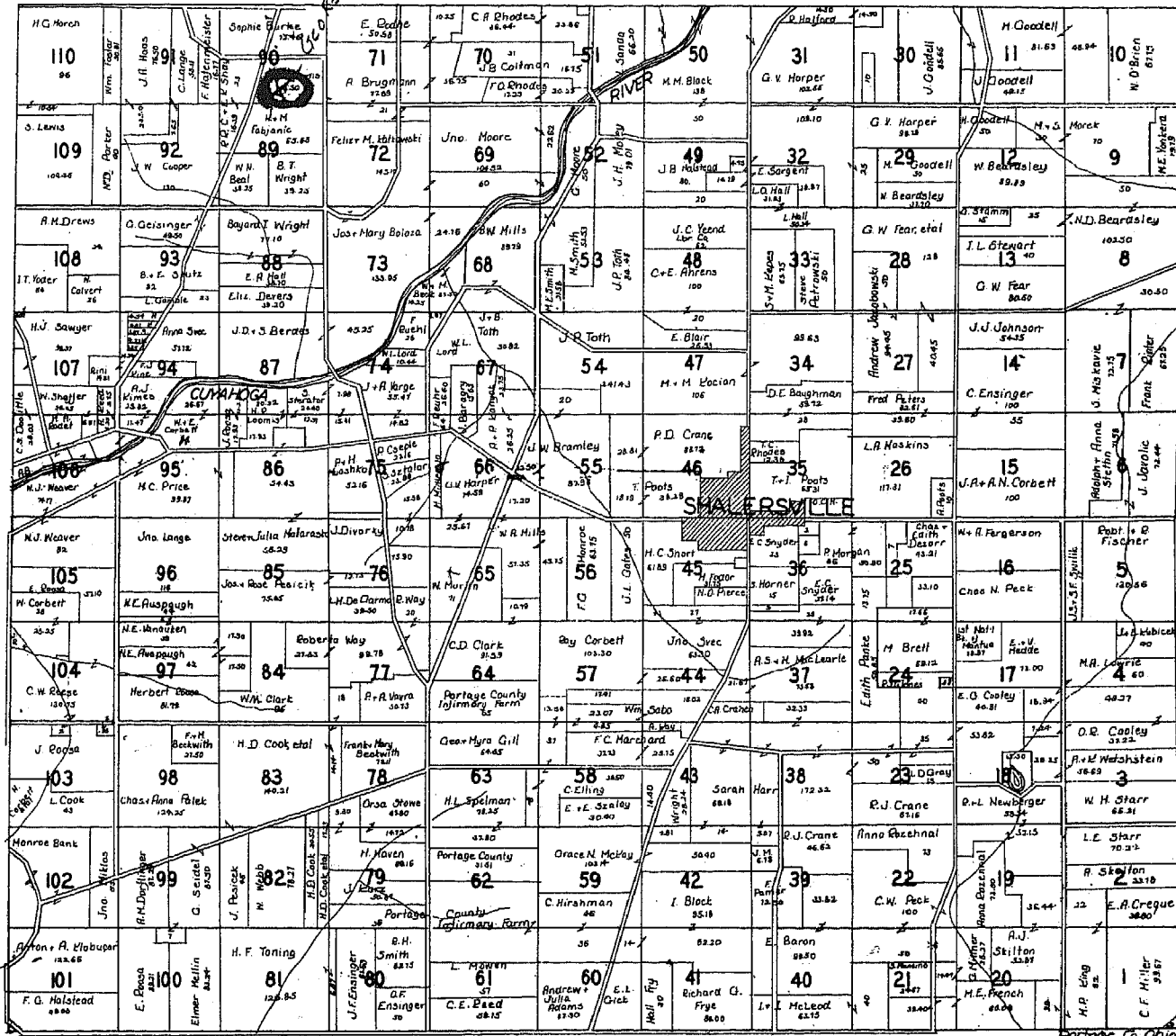

T. 4 N.

STREETSBORO

R. 9 W.

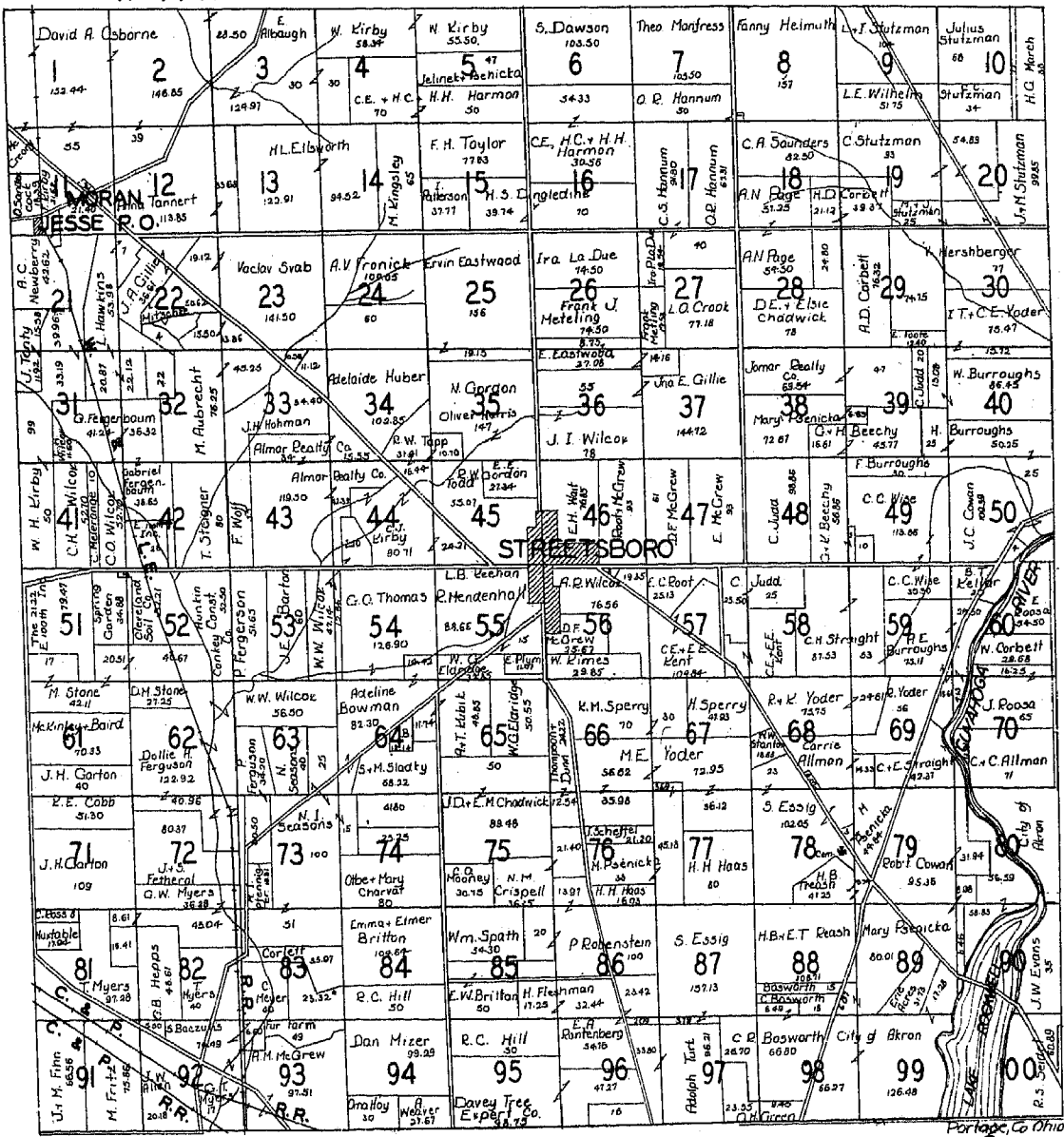

T. 1 N. SUFFIELD R. 9 W.

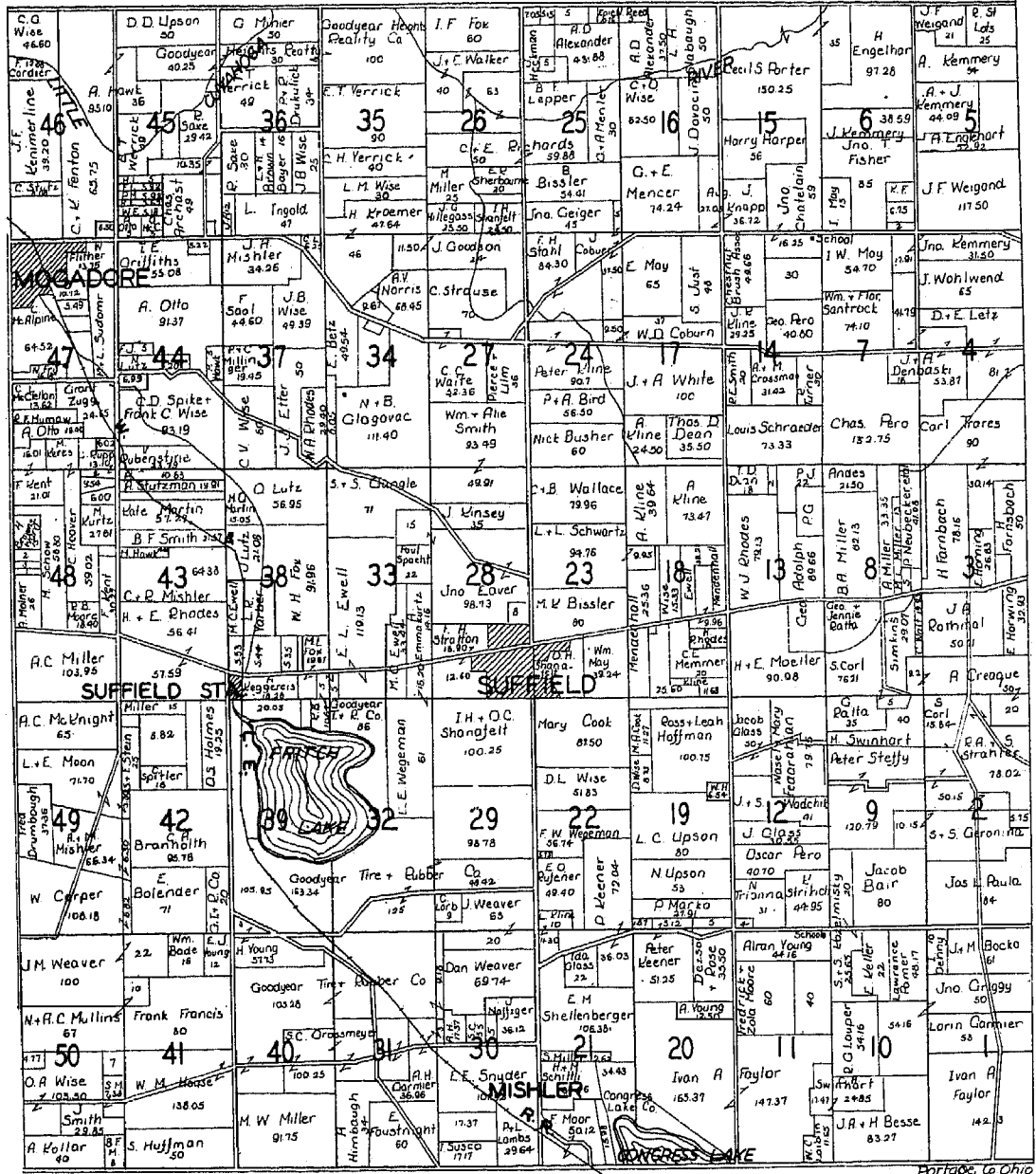

T. 4 N. WINDHAM R 6 W.

